

# Skookum Anchor Shackles

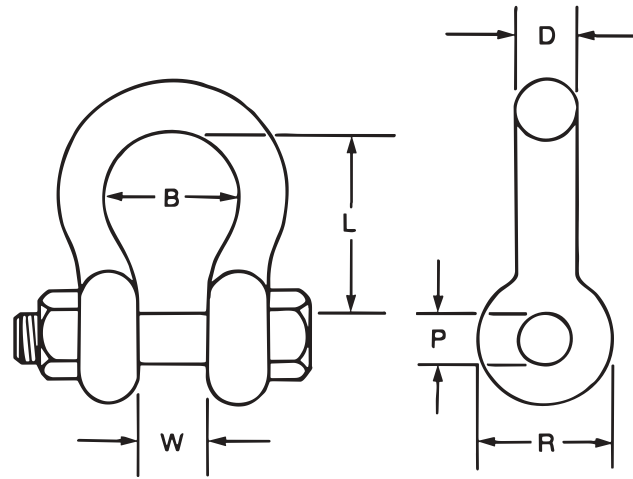

**Safety Pin Shackle**

Available 1/2" to 4-1/2"

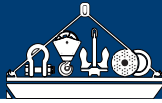

**Screwpin Shackle Eyed Pin**

Available 1/2" to 3"



**Screwpin Shackle Hex Head Pin or Marine Hex Head**

Available 1/2" to 4"

- Shackles are also available in Chain Pattern Styles.
- Towing Shackle Double Nut and Locking Bolts are also available in Anchor and Chain Patterns.

*Size	SWL <sup>1</sup> (Tons)	Nominal D	W	Tol. ±	L	Tol. ±	B	R	P	Wt <sup>2</sup> (lbs)
1/2	5	5/8	13/16	1/16	1-7/8	± 1/8	1-9/32	1-7/16	5/8	.75
5/8	7	3/4	1-1/16	1/16	2-1/2	± 1/8	1-3/4	1-5/8	3/4	1.5
3/4	9	7/8	1-1/4	1/16	2-7/8	± 1/4	2	1-27/32	7/8	2.2
7/8	12	1	1-7/16	1/16	3-5/16	± 1/4	2-9/32	2-1/8	1	3.7
1	16	1-1/8	1-11/16	1/16	3-3/4	± 1/4	2-11/16	2-1/4	1-1/8	5.5
1-1/8	18	1-1/8	1-13/16	1/16	4-1/4	± 1/4	2-15/16	2-5/8	1-1/4	7.2
1-1/4	21	1-1/4	2-1/32	1/16	4-5/8	± 1/4	3-1/4	3	1-3/8	10.5
1-3/8	26	1-3/8	2-1/4	1/8	5-1/4	± 1/4	3-5/8	3-1/4	1-1/2	13.8
1-1/2	31	1-1/2	2-3/8	1/8	5-3/4	± 1/4	3-7/8	3-7/16	1-5/8	18.5
1-5/8	35	1-5/8	2-5/8	1/8	6-1/4	± 1/4	4-5/8	4	1-3/4	23
1-3/4	41	1-3/4	2-7/8	1/8	7	± 1/4	5	4-1/4	2	29.5
2	52	2	3-1/4	1/8	7-3/4	± 1/2	5-3/4	5	2-1/4	42.0
2-1/4	67	2-1/4	3-7/8	1/8	9-1/4	± 1/2	6-1/2	5-1/2	2-1/2	60.0
2-1/2	82	2-1/2	4-1/8	1/8	10-1/2	± 1/2	7-1/4	5-7/8	2-3/4	90.0
2-3/4	104	2-3/4	4-1/2	1/8	11-1/2	± 3/4	7-1/2	6-1/4	3	115
3	117	3	5	1/8	13	± 3/4	7-7/8	6-1/2	3-1/4	150
3-1/2	150	3-1/2	5-3/4	1/4	15	± 3/4	9-1/2	8	3-3/4	250
4	175	4	6-1/2	1/4	17	± 3/4	11	9	4-1/4	350
4-1/2	210	4-1/2	7-1/4	1/4	19	± 1-1/8	12-1/2	9-3/4	5	475

\*Dimensions are in inches and weights are in pounds.

<sup>1</sup>Design factor is 5 to 1.

<sup>2</sup>Weights vary slightly with style of shackle pin used.